

atrin **electronic**

Expertise, variety and quality



www.atrinelec.com

آترین الکترونیک

تخصص، تنوع و کیفیت

02166766957 - 02166766927



info@atrinelec.com



تهران پاساژ امجد طبقه 1 واحد 16



@atrinelec



COMPLEMENTARY SILICON POWER TRANSISTORS

- SGS-THOMSON PREFERRED SALESTYPES
- COMPLEMENTARY PNP - NPN DEVICES

DESCRIPTION

The BD433, BD435, and BD437 are silicon epitaxial-base NPN power transistors in Jedec SOT-32 plastic package, intended for use in medium power linear and switching applications.

The BD433 is especially suitable for use in car-radio output stages.

The complementary PNP types are BD434, BD436, and BD438 respectively.

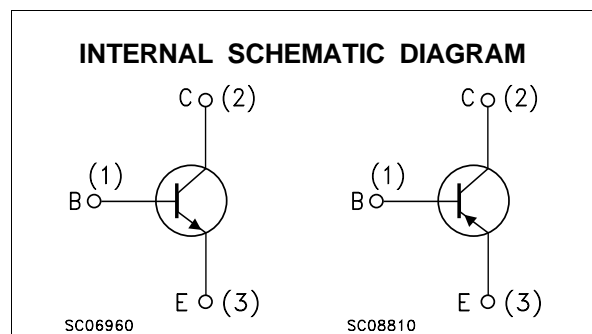
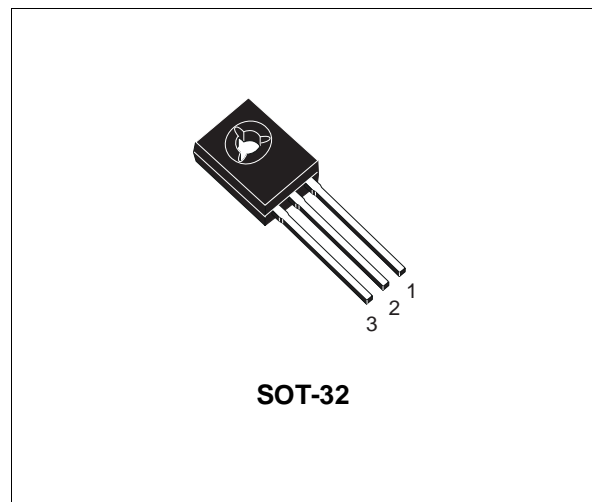

ABSOLUTE MAXIMUM RATINGS

| Symbol | Parameter | Value | | | | Unit |
|-----------|--|-------|------------|-------|-------|------|
| | | NPN | BD433 | BD435 | BD437 | |
| | | PNP | BD434 | BD436 | BD438 | |
| V_{CBO} | Collector-Base Voltage ($I_E = 0$) | | 22 | 32 | 45 | V |
| V_{CES} | Collector-Emitter Voltage ($V_{BE} = 0$) | | 22 | 32 | 45 | V |
| V_{CEO} | Collector-Emitter Voltage ($I_B = 0$) | | 22 | 32 | 45 | V |
| V_{EBO} | Emitter-Base Voltage ($I_C = 0$) | | 5 | | | V |
| I_C | Collector Current | | 4 | | | A |
| I_{CM} | Collector Peak Current ($t \leq 10$ ms) | | 7 | | | A |
| I_B | Base Current | | 1 | | | A |
| P_{tot} | Total Dissipation at $T_c \leq 25$ °C | | 36 | | | W |
| T_{stg} | Storage Temperature | | -65 to 150 | | | °C |
| T_j | Max. Operating Junction Temperature | | 150 | | | °C |

For PNP types voltage and current values are negative.

BD433/434/435/436/437/438

THERMAL DATA

| | | | | |
|-----------------------|-------------------------------------|-----|-----|------|
| R _{thj-case} | Thermal Resistance Junction-case | Max | 3.5 | °C/W |
| R _{thj-amb} | Thermal Resistance Junction-ambient | Max | 100 | °C/W |

ELECTRICAL CHARACTERISTICS (T_{case} = 25 °C unless otherwise specified)

| Symbol | Parameter | Test Conditions | Min. | Typ. | Max. | Unit |
|--------------------------------------|---|---|---|--|--------------------------|----------------|
| I _{CBO} | Collector Cut-off Current (I _E = 0) | for BD433/434 V _{CB} = 22 V for BD435/436 V _{CB} = 32 V for BD437/438 V _{CB} = 45 V | | | 100 100 100 | μA μA μA |
| I _{CES} | Collector Cut-off Current (V _{BE} = 0) | for BD433/434 V _{CE} = 22 V for BD435/436 V _{CE} = 32 V for BD437/438 V _{CE} = 45 V | | | 100 100 100 | μA μA μA |
| I _{EBO} | Emitter Cut-off Current (I _C = 0) | V _{EB} = 5 V | | | 1 | mA |
| V _{CEO(sus)*} | Collector-Emitter Sustaining Voltage (I _B = 0) | I _C = 100 mA | for BD433/434 22 for BD435/436 32 for BD437/438 45 | | | V V V |
| V _{CE(sat)*} | Collector-Emitter Saturation Voltage | I _C = 2 A | I _B = 0.2 A for BD433/434 for BD435/436 for BD437/438 | 0.2 0.2 0.2 | 0.5 0.5 0.6 | V V V |
| V _{BE*} | Base-Emitter Voltage | I _C = 10 mA I _C = 2 A | V _{CE} = 5 V V _{CE} = 1 V for BD433/434 for BD435/436 for BD437/438 | 0.58 | 1.1 1.1 1.2 | V V V |
| h _{FE*} | DC Current Gain | I _C = 10 mA I _C = 500 mA I _C = 2 A | V _{CE} = 5 V for BD433/434 for BD435/436 for BD437/438 V _{CE} = 1 V V _{CE} = 1 V for BD433/434 for BD435/436 for BD437/438 | 40 40 30 85 50 50 40 | 130 130 130 140 | |
| h _{FE1} /h _{FE2} * | Matched Pair | I _C = 500 mA | V _{CE} = 1 V | | 1.4 | |
| f _T | Transition frequency | I _C = 250 mA | V _{CE} = 1 V | 3 | | MHz |

* Pulsed: Pulse duration = 300 μs, duty cycle 1.5 %

SOT-32 (TO-126) MECHANICAL DATA

| DIM. | mm | | | inch | | |
|------|------|------|------|-------|-------|-------|
| | MIN. | TYP. | MAX. | MIN. | TYP. | MAX. |
| A | 7.4 | | 7.8 | 0.291 | | 0.307 |
| B | 10.5 | | 10.8 | 0.413 | | 0.445 |
| b | 0.7 | | 0.9 | 0.028 | | 0.035 |
| b1 | 0.49 | | 0.75 | 0.019 | | 0.030 |
| C | 2.4 | | 2.7 | 0.040 | | 0.106 |
| c1 | 1.0 | | 1.3 | 0.039 | | 0.050 |
| D | 15.4 | | 16.0 | 0.606 | | 0.629 |
| e | | 2.2 | | | 0.087 | |
| e3 | 4.15 | | 4.65 | 0.163 | | 0.183 |
| F | | 3.8 | | | 0.150 | |
| G | 3 | | 3.2 | 0.118 | | 0.126 |
| H | | | 2.54 | | | 0.100 |
| H2 | | 2.15 | | | 0.084 | |

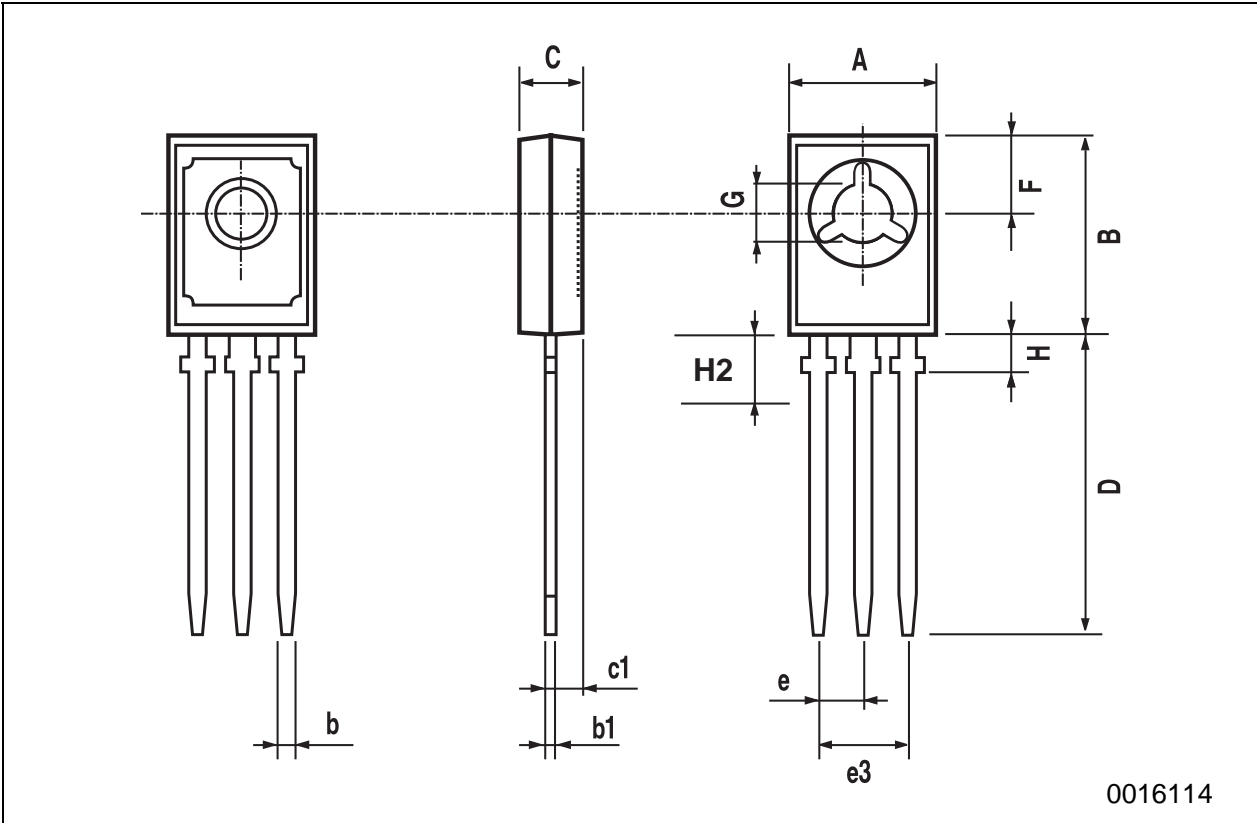

0016114

Information furnished is believed to be accurate and reliable. However, SGS-THOMSON Microelectronics assumes no responsibility for the consequences of use of such information nor for any infringement of patents or other rights of third parties which may result from its use. No license is granted by implication or otherwise under any patent or patent rights of SGS-THOMSON Microelectronics. Specifications mentioned in this publication are subject to change without notice. This publication supersedes and replaces all information previously supplied. SGS-THOMSON Microelectronics products are not authorized for use as critical components in life support devices or systems without express written approval of SGS-THOMSON Microelectronics.

© 1997 SGS-THOMSON Microelectronics - Printed in Italy - All Rights Reserved

SGS-THOMSON Microelectronics GROUP OF COMPANIES
Australia - Brazil - Canada - China - France - Germany - Hong Kong - Italy - Japan - Korea - Malaysia - Malta - Morocco - The Netherlands -
Singapore - Spain - Sweden - Switzerland - Taiwan - Thailand - United Kingdom - U.S.A
...